

ECC9292S

Electrolux Range Hood

User Manual

Enjoy peace of mind. Register your appliance today.

Stay updated on better living services,
safety notices and shop for accessories.

- 1. Open the camera app on your smartphone and point at the QR code to scan.**

Product Registration QR code is located on the front or underside of your appliance.

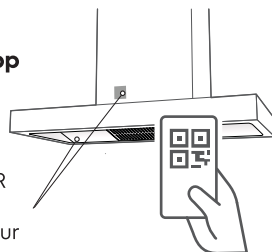

- 2. Tap the notification or link to open the registration form.**
- 3. Complete your details and enjoy peace of mind.**

Contents

1. Product Description	3	7. Instructions for Use	7
2. Precautions	3	8. Maintenance.....	10
3. Packing List	4	9. Troubleshooting.....	11
4. Technical Specifications	4	10.Part Names	12
5. Schematic Circuit Diagram.....	4	11.Custoer care center	13
6. Installation Instructions.....	5		

Customer Care and Service

The following symbols will be used in this manual, with their explanations as follows:



Warning! Important information relating to protection of personal safety and avoidance of electrical damage.



General information and advice



Environmental protection information

1. Product Description

The romantic European range hood has the following six advantages:













1. Futuristic design, up-to-date styling
Streamlined design, elegant and stylish appearance, and touch control, fully showing the cooking experience of blues style.
2. Large suction and complete removal of fume
The integral stretched hood is more suitable for the fume collection area of kitchens, and the fan with a large exhaust rate is used to exhaust fume more thoroughly.
3. Low noise
According to the principle of aerodynamics, the well-designed exhaust system guarantees smooth and quiet operation.
4. Easy maintenance
Large conical strainers for air intake are designed on four sides to ensure thorough fume suction, avoid spillage of residual oil, and smoothly converge residual oil into the oil cup, while avoiding the weakness in the maintenance of traditional European range hoods.
5. Circuit characteristics
A unique multi-circuit design is used to ensure no accumulation, no dripping, or seepage.

2. Precautions

(1) Child Safety

-  1. Do not allow children to extend their fingers or other parts of the body into the range hood.
Warning: Destroy or recycle the appliance's carton, plastic bags, and any other exterior wrapping material immediately after the product is unpacked. Children should never play with these items. Danger of suffocation!

(2) Precautions for Use

-  1. Always use a power supply compliant with the requirements of the appliance. A three-pin power socket must be reliably grounded.
-  2. The wall on which the range hood will be installed should be strong enough to bear the dead weight of the range hood itself. The wall must be non-combustible.
-  3. Do not expose the range hood to fire directly.
-  4. Protect the motor, switches and other electrical parts against water.
-  5. Do not change the specifications of electrical parts, change the internal circuit, or connect other lines.
-  6. Do not scratch, knot, or squeeze the power cable.
-  7. If any abnormal conditions occur during use, refer to the troubleshooting section for solutions before contacting the customer service centre. If the fault persists, unplug the power plug of the range hood and contact our customer service centre.
-  8. If the light is damaged, replace it with a new one with the same specifications.
-  9. This appliance is for household use only instead of unintended purposes.
-  10. When oil residue stored in the oil cup reaches two thirds of its capacity, clean immediately to prevent spillage.
-  11. Do not dismantle and repair the appliance without authorization. Otherwise, serious consequences may be followed.
-  12. If users do not clean the range hood according to the instructions, there is a risk of fire.

i 13. The room must be well-ventilated when the range hood is used in a place where gas or other fuel is combusted (but the range hood should not be installed in a place with large convection. Otherwise, the suction performance will be degraded).

i 14. The gas discharged from the range hood cannot be discharged into the waste smoke tube of burning gas or other fuels.

(3) Environmental Protection

"Environmental protection, benefit of mankind, pollution prevention, and continuous improvement" are the philosophy our company's environmental management. The environmental impact caused by our products in use and after service life is hereby warned to you as follows:

🌿 Waste cartons and plastic bags are recyclable while waste foam is not. Properly classify these wastes after unpacking.

3. Packing List

Please check the items in the package against the packing list. If there is any missing or lost item:

1. Please ask the vendor to handle this if it is the responsibility of the company or vendor.
2. Please contact the vendor or the company if it is your responsibility.

S/N	Name	Qty	S/N	Name	Qty
1	Appliance	1 set	8	Aluminium foil exhaust pipe	1 pcs
2	User manual	1 pc	9	Decorative cover mounting plate	2 pcs
3	Warranty card	1 pc	10	Special screws for decorative cover, safety block, ST5X19 screws, expansion tube, and wood screws	1 bag
4	Oil cup	1 pc			
5	Appliance mounting plate	1 pcs			
6	Air outlet	1 pc			
7	Exhaust pipe adapter	1 pc			

4. Technical Specifications

Model	ECC9292S
Outline dimension (mm)	Length 899 mm × Width 515 mm × Height (Min. 698 mm/Max. 1012 mm)
Net weight (kg)	33
Power supply (V)	220 V-240 V/50 Hz
Rated total input power (W)	223
Motor input power (W)	220
Lighting power (W)	1.5 W × 2

5. Schematic Circuit Diagram

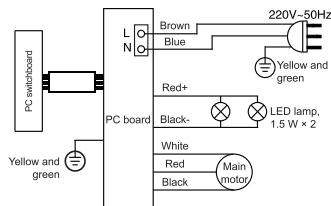

6. Installation Instructions

I. Installation Requirements

1. The wall on which the appliance is installed should be strong enough to bear the dead weight of the appliance.
2. The range hood must not be in contact with the electrical lines inside and outside the wall. Otherwise, there is a risk of electric shock.
3. The range hood should not be installed in a place with large convection. Otherwise, the suction performance will be degraded.
4. The range hood should be securely installed on the wall 650 mm above the cooker. The lower the height, the better the suction performance.
5. The distance between the air outlet of the range hood and the upper exhaust hole should be less than or equal to 1.5 m, so as to avoid degraded suction performance because of too long air outlet or too many turns (generally one turn).
6. The following figure shows the installation dimension of the air outlet when it is mounted to the cupboard or ceiling.

II. Installation Method

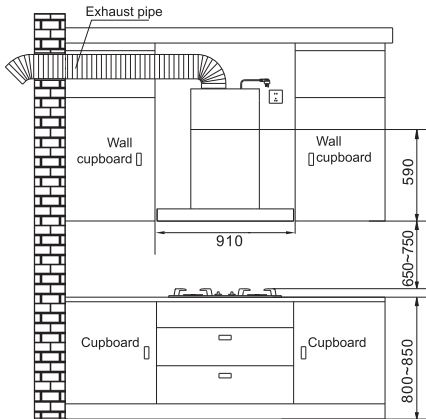

Schematic diagram of mounting the appliance to cupboards

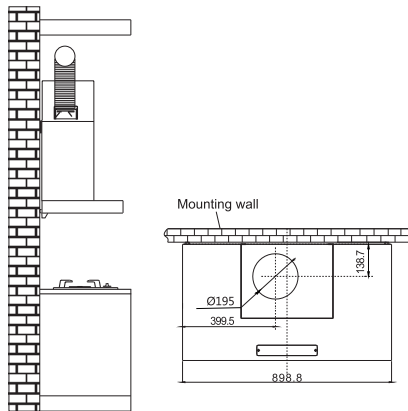

Schematic diagram of mounting the appliance to the ceiling

- (1) The reference distance from the bottom of the range hood to the cookware supporting surface on the stove is 650 mm.
- (2) Identify the hole location, drill two holes with a diameter of 10 mm, a depth of 53 mm and a spacing of 180 mm on the wall, and bury the expansion pipes in the holes.
- (3) Secure the mounting plate to the wall with two $\phi 5 \times 53$ mm wood screws.
Note: Avoid electric wires inside the wall while drilling. Otherwise, there is a risk of electric shock.
- (4) Remove the eight self-tapping screws from the air outlet assembly using a Phillips screwdriver, and remove the rubber gasket.
- (5) Place the rubber gasket and air outlet assembly onto the air outlet in turns, and align them with the screw holes. After the screw holes are aligned, secure the rubber gasket and air outlet assembly to the mainframe using the eight self-tapping screws removed in Step 1.

- (6) Remove the exhaust pipe and the short adapter (both have been fixed with aluminum foil tape), and press the exhaust pipe. Pass the air outlet cover from top to bottom through the exhaust pipe and short adapter to the end. Then fasten and interlock the above assembly to the air outlet seat with the four buckles on the air outlet cover. Connect the power supply, start the motor, and check whether the two metal pieces turn up. The two metal pieces should fall back naturally when the appliance is turned off.
 - (7) Lift the appliance, align the hanging holes on the back of the mainframe with the hooks on the mounting plate, and check that the appliance is installed horizontally and stably.
Use one screw (ST5X19) to fix the appliance block on the wall through the plastic expansion pipe to prevent the appliance from falling off in the vertical direction when it is subjected to external forces.
 - (8) Direct connection is possible when the aperture of the smoke outlet on the kitchen wall is larger than the outer diameter of the exhaust pipe. Otherwise, cut off the excess part of the exhaust pipe connector smaller than the smoke outlet as required, connect the exhaust pipe and exhaust pipe connector with adhesive tape, and install it into the smoke outlet.
 - (9) To connect the exhaust pipe vertically to the outside wall, please extend the exhaust pipe at least 30 mm outside the wall. The air outlet of the exhaust pipe should be slightly inclined downward to avoid rainwater flowing backwards.
 - (10) To install a decorative cover, determine the position of the mounting hole of the decorative cover mounting plate according to the installation diagram.
 - (11) Drill 4 holes with a diameter of 10 mm and a depth of 50 mm at the corresponding place by using a percussion drill, embed the plastic expansion pipe and fix 2 brackets for the upper decorative cover on the wall with 4 screws ($\varnothing 5 \times 53$).
 - (12) Pull out the upper decorative cover, adjust the height of the upper decorative cover and hook it to the mounting hole. Align the holes on both sides of the upper decorative cover with the anchor holes of the bracket, and secure them with four stainless steel screws ($M4 \times 12$) with gaskets. (Note: Be careful while pulling out the upper cover and pay attention to sharp edges around the product to avoid cuts.)
- Align the hanging lugs at both ends of the oil cup with the slots on the two oil cup brackets at the lower end of the rear of the range hood, push the oil cup horizontally inward, and check that the oil cup is securely installed.

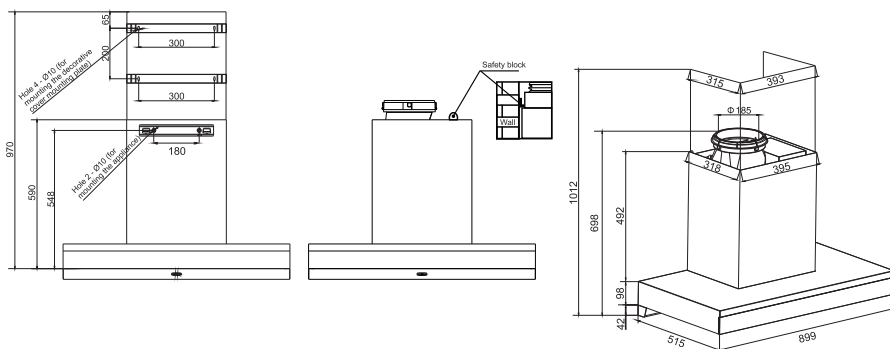

III. Installation Checks

The user should first check whether the range hood is well installed.

IV. Power Settings

After confirming that the range hood is installed properly, connect into the reliably grounded power socket.

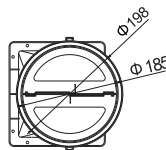

Installation range of the exhaust pipe:
inner diameter >Φ185 mm;
external diameter <Φ198 mm

7. Instructions for Use



Power ①

When you tap the "Power" button or wave your hand right, the buzzer sounds and all white button indicator lights are lit up. The red LED indicator lights turn on from left to right. If there is a speed setting memory, the fan is turned on in the memorized speed setting. Otherwise, the fan is turned on in speed 2, and the red power indicator light, the red indicator lights for the corresponding speed setting and lower speed settings, and the breeze refresh indicator light are turned on. Enter the on state. With power on, when you tap the "Power" button, the buzzer sounds, and all the button lights and indicator lights are turned off (The light is not affected). The clock is steadily on and the appliance is turned off.

Fan Speed Settings

With power on, you can tap the "1", "2", "3", "4", or "5" button or wave your hand left or right to set the fan speed with a beep sound. The indicator light for the fan speed button you tap, the breeze refresh indicator light, and the indicator lights with lower speed setting are displayed in red. You can switch fan speed freely among "1", "2", "3", "4", and "5" by tapping the fan speed key or using gestures.

Power boost

With power on, when you tap the "Power boost" button, the buzzer sounds, and all the speed settings are displayed. The fan will return to the original speed setting after the speed setting in Power boost mode runs for 1 minute. When you tap the "Power boost" button again within 1 minute, the fan will restore its original speed setting with a beep sound. If you wave your hand right within 1 minute, the appliance will not respond, and if you wave your hand left, speed setting 5 is enabled.

Power boost for 1 minute, and the clock should display countdown. Directly press other speed setting buttons to enter the corresponding speed setting.

Breeze refresh

With power on, when you tap the "Breeze refresh" button, the Breeze refresh function is enabled, and the red indicator light for the button blinks. The fan runs for 5 minutes in speed setting 1 every one hour. The screen displays a 5-minute countdown, and the clock is displayed for the other 55 minutes after the countdown. You can press and hold the "Breeze refresh" button again for 3 minutes or swipe right to cancel Breeze refresh. The fan starts in speed setting 2. You can tap the "Power" button or swipe left to shut down the appliance.

Light

In standby/on state, when you tap the "Light" button, the buzzer sounds, the Light button is lit up, the corresponding red indicator light is lit up, and the light turns on (high illumination). You can tap the "Light" button again to switch from high illumination to low illumination, repeat the operation to turn off the indicator light and the light, and repeat the operation again to enable high illumination, and so on and so forth.

Delay Off

With fan on, when you tap the "Delay" button or control the appliance with gestures, that is, swiping left in speed setting 1, the buzzer sounds, the red indicator light for the Delay button blinks, the system starts to execute the "Delay Off" function. The fan runs in speed setting 1, the red indicator light for speed setting 1 turns on, and the screen starts to count down (by default, the countdown starts from 5 minutes). You can tap the "Delay" button again to change the time from 5 minutes to 10 minutes, repeat the operation to change the time from 10 minutes to 15 minutes, and repeat the operation again to disable the delay off function and restore speed setting 2. When the delay function is on, press and hold the delay button for 3 seconds or wave your hand to the right to exit the delay and restore speed setting 2 directly. Press the power button or wave your hand left to turn off the appliance. Upon completion of delay off, the appliance is shut down and the light turns off.

Filter clean reminder

After the appliance is powered on for the first time, the system will accumulate the operation time of the appliance. When the operation time reaches 50 hours, the red indicator light for the Clean button will blink. Users need to remove the filter for cleaning. Press and hold the "Filter Clean" button for 3 seconds after the filter is reinstalled to clear the alarm (The 50-hour timer starts again).

Clock setting

With power off, press and hold the "Power" button and "Light" button for 3 seconds to enter the clock setting mode. The clock flashes, the "1", "2", "3", "4", "5" buttons and the red indicator lights are lit up. Press and hold "1" and "2" to change the hour, "1" to decrease the value, "2" to increase the value, and the input range is 1-12. Press and hold "1" and "2" to continuously change the number. Press and hold "3" and "4" to change the minute, "3" to decrease the value, "4" to increase the value, and the input range is 0-59. Press and hold "3" and "4" to continuously change the number. Press "5" to switch between AM and PM. In the clock setting mode, tap the "Power" button or "Light" button or the appliance is inactive for 3 seconds, the appliance is turned off.

Gesture Settings

With power off, press and hold the "Power" button for 3 seconds to enter the gesture setting mode, and the "1" and "2" buttons are lit up. All shipped appliances feature the gesture function by default. The red indicator for the "1" button is lit up, and the function screen displays "on". When you tap the "2" button, the red indicator for the "2" button is lit up, and the red indicator for the "1" button is turned off. At this time, the gesture function is turned off and the screen displays "off". In

gesture setting mode, if you tap the "Power" button or "Light" button, or the appliance is inactive for 3 seconds, the appliance is turned off and the gesture function is set.

Gesture Function

When the appliance is turned off, if you wave your hand left, the appliance remains off without response. You can wave your hand right to start the appliance. The appliance starts in speed setting 2 for the first time. The appliance will start in the last speed setting in later uses (not ventilation or delay mode).

When the appliance is operating, you can wave your hand left to reduce speed setting from power boost, 5, 4, 3, 2, 1, delay off to shutdown, or wave your hand right to increase speed setting from 1, 2, 3, 4, 5 to power boost, and then maintain at the power boost mode without other response.

When the "Delay Off" function is enabled, you can wave your hand left to shut down the appliance, or wave your hand right to start the appliance in speed setting 2.

When the breeze refresh function is enabled, you can wave your hand left to shut down the appliance, or wave your hand right to start the appliance in speed setting 2.

(In clock setting mode, the appliance does not respond when you wave your hand left or right.

In gesture setting mode, the appliance does not respond when you wave your hand left or right.)

1. Removal of the light:

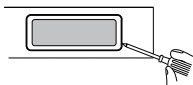

(1) Extend a small slotted screwdriver or similar objects into the gap between the light cover and the hood.

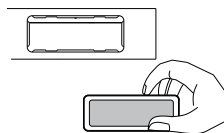

(2) Pry up the light from the hood and disconnect the connector. The light can be replaced.

2. Removal of the switch

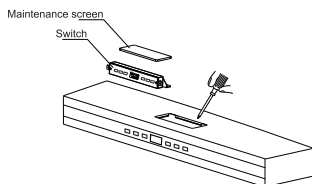

On the upper part of the mainframe (as shown in the figure), use a screwdriver to unscrew the maintenance screen, remove the maintenance screen, use a screwdriver to unscrew the switch, then remove the switch.

8. Maintenance

Maintenance guarantees good performance. Please take good care of your appliance.

Be sure to cut off the power supply before any maintenance operations (hold the plug and remove it).

Perform maintenance operations with gloves to prevent cuts by sharp edges of the appliance.

Remove oil stains on the surface of the strainer and mainframe regularly, and keep the appliance clean.

The strainer should be cleaned after every 3 months of use to ensure proper smoke suction and exhaust performance.

Perform total preventive maintenance every year to clean oil stains and guarantee good performance.

It is strictly forbidden to clean the appliance with strong detergent or flammable detergent.

During cleaning and maintenance, the appliance may be triggered, which is not a product quality defect.

Removal of Parts

Handle with care while disassembling parts to avoid distortion or damage.

- (1) Pull down to remove the oil collector.
- (2) Remove the screws securing the strainer and remove the strainer.
- (3) Remove the screws securing the external decorative cover (on the rear) and remove the decorative cover.
- (4) Remove the screws securing the case cover and remove the case cover.
- (5) Remove the screws securing the guide ring and remove the guide ring.
- (6) Remove the wind wheel cap in the direction as indicated by the arrow and remove the wind wheel.
- (7) After maintenance operations, reinstall parts in the reverse order of removal.

Cleaning of Parts

- (1) Please use neutral detergent, soft cloth and soft brush for cleaning parts. Do not use organic solvents.
- (2) Please soak parts for 30 minutes before cleaning. Avoid deformation or damage during cleaning.
- (3) Upon completion of part cleaning, rinse parts with fresh water and wipe dry with a soft cloth.
- (4) Use a soft dry cloth or soft brush to clean the electrical parts, instead of water or detergent.
- (5) If users do not clean the appliance according to the instructions, there may be a risk of fire.

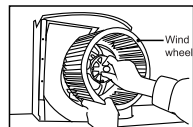
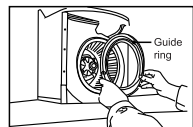
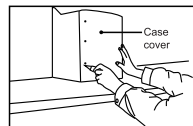
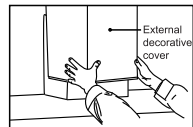
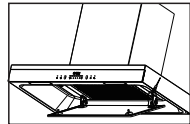

Note: The range hood should be maintained by skilled personnel.

9. Troubleshooting

- Always remove the power plug before troubleshooting

Problem	Possible Cause	Solution
Both the light and motor do not work	The power plug is not properly connected	Connect the power plug properly
	No power output	Ask an electrician for help
The motor works but the light is not lit up	The light is damaged	Replace with a new light (Please contact our customer service centre for door-to-door service)
	The PC board is damaged	Replace with a new PC board (Please contact our customer service centre for door-to-door service)
The light works but the AC motor does not work	The capacitor has poor contact or is damaged	Please contact our customer service centre for door-to-door service
	The motor is damaged or the power board is damaged	Please contact our customer service centre for door-to-door service
The running wind wheel is noisy	The wind wheel is loose and the cap is not tightened	Tighten the cap
Speed setting 1 is unavailable Other speed settings are available	The control switch is faulty	Replace with a new switch (Please contact our customer service centre for door-to-door service)
Poor suction performance	Too high installation height	Reduce the installation height
	Two wind screens are not completely opened	Check that wind screens should be flexibly rotated
	Too large convection around the appliance	Close doors and windows if applicable
	Too much oil stain	Clean oil stain
	Maximum speed is not set	Set to the maximum speed
The DC motor does not work	The main power board does not communicate information to the motor	Replace with a new PC board (Please contact our customer service centre for door-to-door service)

Warning:

1. Please cut off the power supply before connecting or replacing plug-ins.
2. A damaged power cable must be replaced by a skilled person from the manufacturer, its repair department or other similar departments.
3. Do not suck flame into the appliance. Otherwise, there may be a risk of fire.

10. Part Names

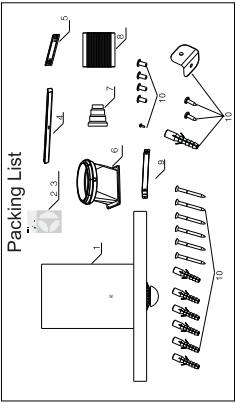
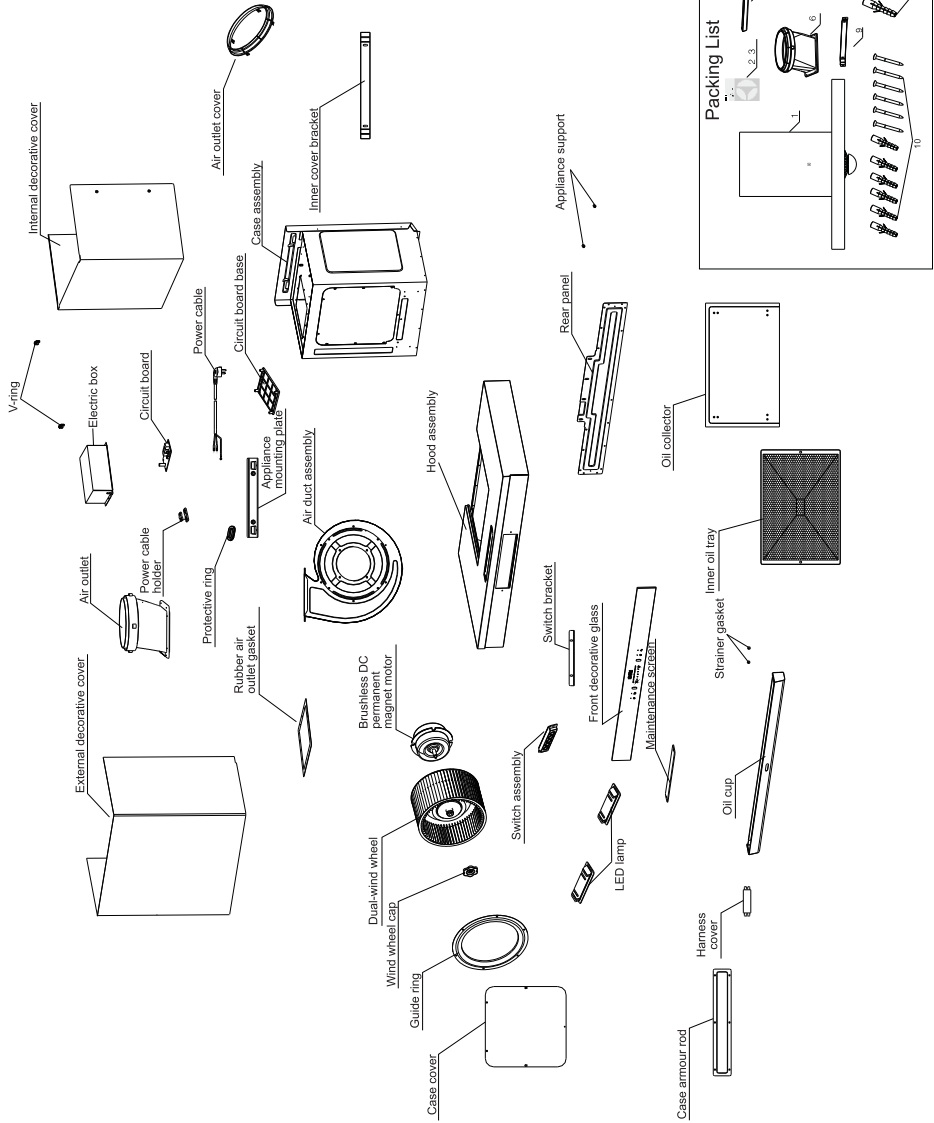

CONSUMER CARE CENTER

<p>Thailand Consumer Care Tel : (+66 2) 725 9000 Electrolux Thailand Co., Ltd. Electrolux Building 14th Floor 1910 New Phetchaburi Road, Bangkapi, Huai Khwang, Bangkok 10310 Office Tel : (+66 2) 7259100 Office Fax : (+66 2) 7259299 Email : customercarethai@electrolux.com</p>	<p>Singapore Consumer Care Center Tel: (+65) 6727 3699 Electrolux S.E.A. Pte Ltd. 351 Braddell Road #01-04, 351 On Braddell Singapore 579713 Email : customer-care.sin@electrolux.com</p>
<p>Indonesia Hotline service: 08041119999 PT. Electrolux Indonesia Electrolux Building Jl.Abdul Muis No.34, Petojo Selatan, Gambir Jakarta Pusat 10160 Email: customercare@electrolux.co.id SMS & WA : 0812.8088.8863</p>	<p>Philippines Consumer Care Center Toll Free: 1-800-10-845-CARE(2273) Consumer Care Hotline:(+63 2)845-CARE(2273) Electrolux Philippines,Inc. Unit B 12F Cyber Sigma Bldg, Lawton Avenue, McKinley West, Taguig, Philippines 1634 Trunkline:+63 2 737-4757 Website:www.electrolux.com.ph Email:wecare@electrolux.com</p>
<p>Vietnam Consumer Care Center Toll Free 1800-58-88-99 Tel: (+84 28) 39105465 Electrolux Vietnam Ltd. Unit 1&2, 10F Sofic Tower, #10 Mai Chi Tho Street, Thu Thiem Ward, Thu Duc City, Ho Chi Minh City, Vietnam</p>	<p>Malaysia Consumer Care Center Tel: 1300-88-11-22 Electrolux Home Appliances Sdn. Bhd. Corporate Office Address: Unit T2-7, 7th Floor, Tower 2, PJ33, No. 3, Jalan Semangat, Seksyen 13, 46200 Petaling Jaya, Selangor. Office Tel : (+60 3) 7843 5999 Office Fax : (+60 3) 7955 5511 Consumer Care Center Address: Lot C6, No. 28, Jalan 15/22, Taman Perindustrian Tiong Nam, 40200 Shah Alam, Selangor Consumer Care Center Fax : (+60 3) 5524 2521 Email : malaysia.customercare@electrolux.com</p>
<p>HONG KONG SERVICE HOTLINE: (+852) 3193 9888 DCH ELECTRICAL APPLIANCES SERVICE CENTRE 4/F, DCH BUILDING, 20 KAI CHEUNG ROAD, KOWLOON BAY, HONG KONG EMAIL: customercare@dch.com.hk WEBSITE: www.electrolux.com.hk</p>	

www.electrolux.com

The Thoughtful Design Innovator.

Do you remember the last time you opened a gift that made you say, “Oh! How did you know? That’s exactly what I wanted!” That’s the kind of feeling that we at Electrolux seek to evoke in everyone who chooses or uses one of our products. We devote time, knowledge, and a great deal of thought to anticipating and creating the kind of appliances that our customers really need and want.

This kind of thoughtful care means innovating with insight. Not design for design’s sake, but design for the user’s sake. For us, thoughtful design means making appliances easier to use and tasks more enjoyable to perform, freeing our customers to experience the ultimate 21st century luxury: ease of mind. Our aim is to make this ease of mind more available to more people in more parts of their everyday lives, all over the world.

The “Thinking of you” promise from Electrolux goes beyond meeting the needs of today’s consumers. It also means we’re committed to making appliances safe for the environment—now and for future generations.

Electrolux. Thinking of you.

Share more of our thinking at
www.electrolux.com



Version No.: MU-H-202303